



**BACK TO**  **11**  
THE ROCK SHOW <sub>0</sub> <sub>11</sub>

LOCAL SHOW  
STAGE PLOT and INPUT LIST

The following is being provided to give general stage plot and input list information for BACK TO 11 for any local show performances where the group will be providing their own backline to a provided event stage within a 500 mile radius of Los Angeles, CA.

This is general information and details and specifications may change based up the event producer's needs and the band's requirements to meet those needs.

Please contact your Back To 11 booking agent or group contact to work out any updates for a particular show.



**STAGE PLOT - LOCAL** (rev 060124)

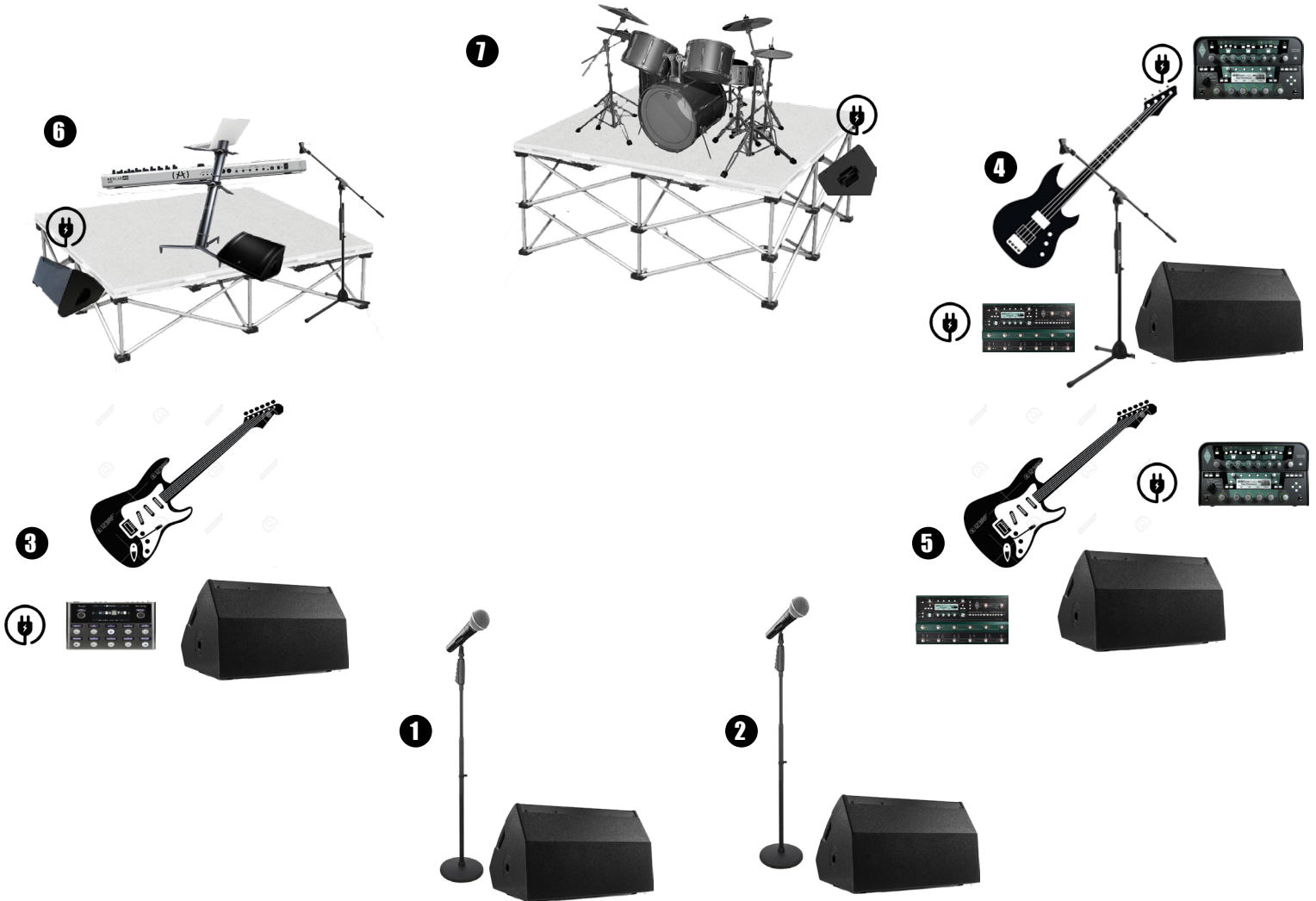

**1 LEAD VOX - ADRIAN**

QLXD Wireless Mic  
Straight Stand  
Wedge Monitor or wireless  
IEM

**2 LEAD VOX - VK**

Sennheiser Wireless Mic\*  
Straight Stand  
Wedge Monitor or wireless  
Sennheiser IEM\*

**3 GUITAR 1 - FLINT**

Edison Drop by pedals  
Wedge Monitor or wireless  
IEM

**4 BASS - DANNY**

Edison Drop by Kemper  
Boom Stand  
Edison Drop by stand  
XLR Cable Drop at stand  
Wedge Monitor or wireless  
IEM

**5 GUITAR 2 - SCOTT**

Edison Drop by Kemper  
Edison Drop by pedals  
Wedge Monitor or wireless  
IEM

**6 KEYS - TONY**

Boom Stand  
Shure SM-58  
Edison Drop  
Stereo XLR Cable Drop  
Wedge Monitor or wireless  
IEM

**7 DRUMS - PAUL**

Edison Drop  
Wedge Monitor or wireless  
IEM



**STAGE INPUT LIST** (rev 060124)

|                | <b>SNAKE</b> | <b>INSTRUMENT</b>      | <b>MIC</b>  | <b>ALT MIC</b>                           |
|----------------|--------------|------------------------|-------------|--|
| <b>DRUMS</b>   | 1            | KICK                   | AUDIX D6    | EV RE20 or Shure Beta 52A                |
|                | 2            | SNARE                  | SHURE SM-57 | Audix i5 or DPA 2011C                    |
|                | 3            | HI-HAT                 | AKG C451    | SENN E914 or Shure SM81                  |
|                | 4            | RACK TOM 1             | AUDIX D2    | SENN MD-421 or Beyer Opus 87             |
|                | 5            | RACK TOM 2             | AUDIX D2    | SENN MD-421 or Beyer Opus 87             |
|                | 6            | RACK TOM 3             | AUDIX D4    | SENN MD-421 or Beyer Opus 87             |
|                | 7            | FLOOR TOM              | AUDIX D4    | SENN MD-421 or Beyer Opus 87             |
|                | 8            | OVERHEAD L             | AKG 414     | AudioTec AT 4050                         |
|                | 9            | OVERHEAD R             | AKG 414     | AudioTec AT 4050                         |
| <b>GUITARS</b> | 10           | BASS                   | D.I.        |  |
|                | 11           | GUITAR 1<br>(FLINT)    | SENN MD-421 | AUDIX I5 or Shure SM57                   |
|                | 12           | GUITAR 2<br>(SCOTT)    | D.I.        |  |
| <b>KEYS</b>    | 13           | KEYS L                 | D.I.        |  |
|                | 14           | KEYS R                 | D.I.        |  |
| <b>VOCALS</b>  | 15           | LEAD VOX 1<br>(ADRIAN) | SENNHEISER  | Quality Shure Wireless                   |
|                | 16           | LEAD VOX 2<br>(VK)     | SENNHEISER* | Quality Shure Wireless                   |
|                | 17           | BASS VOX<br>(DANNY)    | EV RE520*   |  |
|                | 18           | KEY VOX<br>(TONY)      | SHURE SM-58 | Senn e845 or AKG D5<br>* ARTIST PROVIDES |

## BACKLINE REQUIREMENTS (rev 060124)

The following are the backline requirements for BACK TO 11. For any show within 500 miles of Los Angeles where the group will be driving to, some items may not be required and have been marked as "Artist Provides" below. Please check with the group representative to confirm all needs. Where possible, accepted alternatives have been listed. If either the specified equipment or the accepted alternative is not available, please contact the group representative to determine a workable solution.

### VOCALS

- (1) SENNHEISER EW 100 (Lead Vox)\*  
Alt: Shure GLXD System
- (1) SENNHEISER - E835 (Lead Vox)\*  
Alt: Shure SM-58 Wireless
- (1) SHURE ULXD (Lead Vox)  
Alt: Sennheiser EW-D Wireless System or better
- (1) SHURE SM58 WIRE:ESS (Lead Vox)\*  
Alt: Sennheiser E835 Wireless Mic or better
- (1) SHURE SM-58 (Key Vox)  
Alt: Sennheiser e-95
- (2) BOOM STANDS
- (2) STRAIGHT STANDS
- (2) XLR Drops for bass and keys

### GUITARS

- (2) Marshall 4x10 Cabinets
- (1) Hartke 4x10 Cabinet

### KEYBOARDS

- (1) ARTURIA KEYLAB 88 MKII\*  
Alt: Studio Logic SL88 Grand
- (1) Spyder KM-18860 Stand\*  
Alt: Any two-tier, column-style keyboard stand specified for an 88-key size controller.
- (1) Flashpoint FPLTSAT Laptop Stand\*  
Alt: Any stable stand that will safely hold a laptop and a Scarlett Preamp.

### DRUMS

- (1) DW 6.5"x14" SNARE\*  
Alt: Ludwig 6.5"x14" Supraphonic
- (1) YAMAHA 22" RECORDING CUSTOM KICK DRUM\*  
Alt: Yamaha 22" Absolute Hybrid
- (1) YAMAHA 8" RECORDING RACK TOM\*  
Alt: Yamaha 8" Absolute Hybrid
- (1) YAMAHA 10" RECORDING RACK TOM\*  
Alt: Yamaha 10" Absolute Hybrid
- (1) YAMAHA 12" RECORDING RACK TOM\*  
Alt: Yamaha 12" Absolute Hybrid
- (1) YAMAHA 13" RECORDING FLOOR TOM\*

Alt: Yamaha 13" Absolute Hybrid

- (1) MEINI 21" DARK RIDE CYMBAL\*  
Alt: Zildjan K 21" Dark Ride
- (1) MEINI 17", 18", 19" and 20" CRASH CYMBALS\*  
Alt: Zildjan A 17", 18", 19" and 20" Crash
- (1) MEINI 15" PURE ALLOY HI-HAT CYMBALS\*  
Alt: Zildjan A 15" Hi-Hat
- (1) DW 9000 KICK PEDAL\*\*  
Alt: Trick Pro 1-V
- (1) STANDS/HARDWARE  
Quality stands that are adjustable, floor-mounted, and secure
- (1) SIDE TABLE  
Large enough to hold laptop, clip-on light and misc items.
- (1) DRUMSTICK HOLDER\*
- (1) 15" or LARGER FLOOR FAN
- (1) CARPET or OTHER FLOOR COVERING  
Covering needs to securely hold kit in place.

### MONITORS

If providing wedge monitors, please provide separate monitor and mix for the following:

- Lead Vocals (Prefer 2-3 wedges across downstage edge)
- Guitar 1
- Guitar 2
- Bass
- Keyboards (stereo if possible)
- Drums

If providing IEM, please provide separate transmitters and body packs with separate monitor and mix for the following:

- Lead Vocal 1
- Lead Vocal 2
- Guitar 1
- Guitar 2
- Bass
- Keyboards
- Drums

The artists will supply their own IEM ear buds.

\* ARTIST PROVIDES



W: [backto11.com](http://backto11.com) • E: [info@backto11.com](mailto:info@backto11.com) • T: 714.720.8024